



ANALIZADOR DE INSTALACIONES BT - FLUKE 1653 B

Manual de Calibración Suplementario

+5411.2115.9585
contacto@itresenergia.com
www.itresenergia.com

Manual Supplement

Manual Title: 1652C/1653B/1654B Calibration Supplement Issue: **4**
Part Number: Web-Only Issue Date: 4/17
Print Date: March 2011 Page Count: 3
Revision/Date:

This supplement contains information necessary to ensure the accuracy of the above manual.

Change #1

On page 20, replace step 4 with:

- Place PN 1884378 on the touch pad, then touch with the probe as shown in Figure 4.

On page 21, replace Figure 4 with:

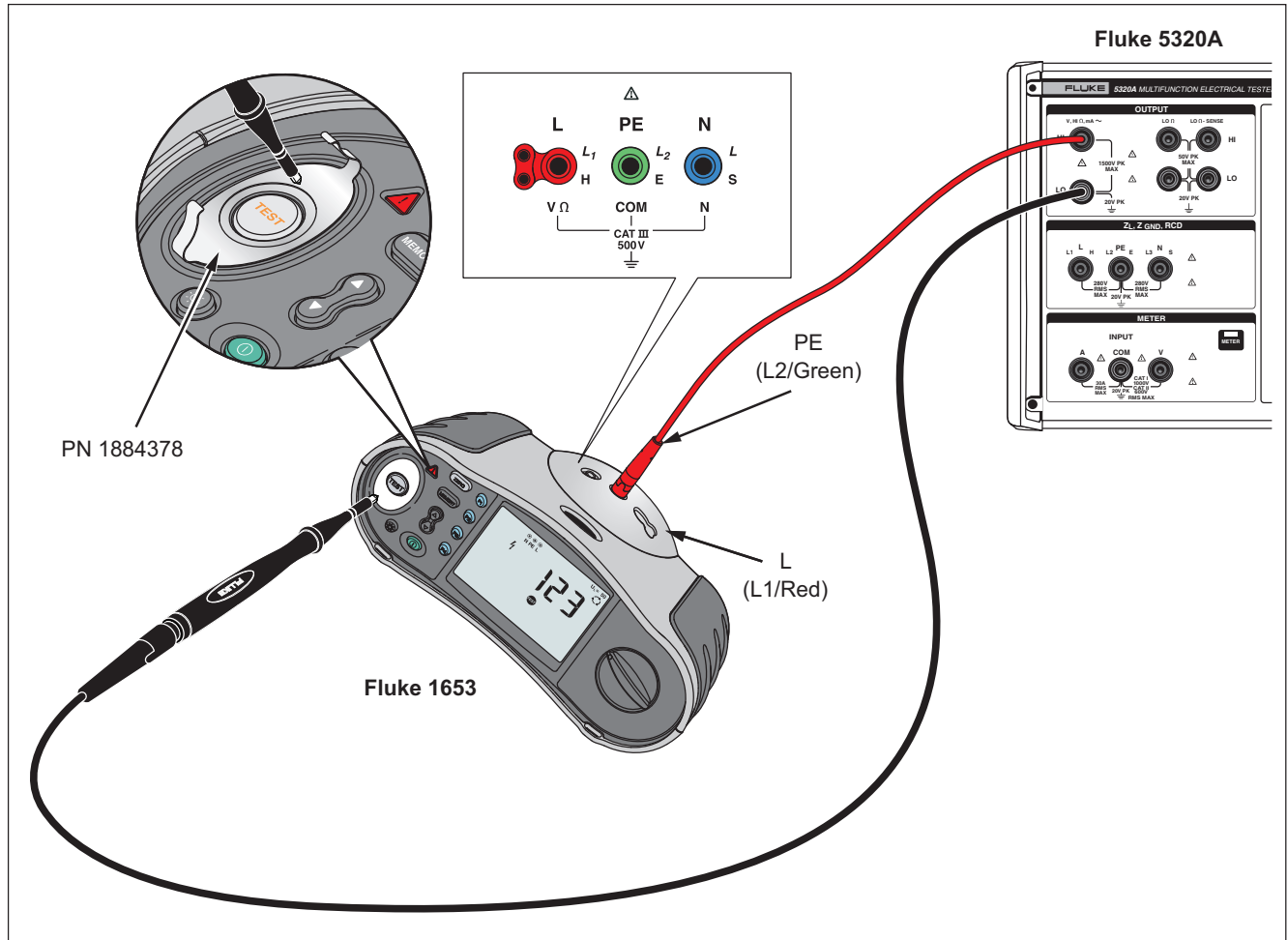

gad002.eps

Figure 4. Touch Pad Sense Test

Change #2

On page 15, add the following to Table 2:

Touch plate	FLUKE-165X-8006, TOUCH PLATE	Fluke P/N 1884378
-------------	------------------------------	-------------------

On page 25, replace steps 1 through 8 with:

1. Set the UUT rotary switch to **LOOP Z_I NO TRIP** function.
2. Using **F1**, set the UUT for L-PE test.
3. Connect test leads to the UUT L-PE-N input jacks. Short the far end of the test leads together with a Zero Adapter (Fluke P/N 3301338). See Figure 8.
4. Press and hold **ZERO** for approximately three seconds until the UUT ZERO \emptyset annunciator appears.

On page 27, replace steps 1 through 7 with:

1. Set the UUT rotary switch to LOOP Z_I HI CURRENT function.
2. Connect test leads to the UUT L-PE-N input jacks. Short the far end of the test leads together with a Zero Adapter (Fluke P/N 3301338). See Figure 8.
3. Press and hold **ZERO** for approximately three seconds until the UUT ZERO \emptyset annunciator appears.

On page 28, replace step 7 with:

7. Using the 5320A cursor keys or keypad, set the 5320A Nominal R Value to the nearest value to those in Table 6 that the 5320A will source. For Steps 1 and 8, take the first value that is $\geq 0.2 \Omega$.

On page 28, replace Table 6 with:

Table 6. Loop Z_I Hi Current Accuracy Test

Step	UUT Function	UUT F1 Setting	5320A Nominal R Value	5320A Residual Impedance Correction Type	Recorded 5320A Displayed Output Z Value	UUT Accuracy Spec. $\pm(\% + \text{dig})$	UUT Res.	Calculated UUT Display Limits	
								Lower	Upper
1	Loop Z _I Hi Current	L-PE	0.2 Ω	Comp		+ (2 % + 4)	0.01 Ω		
2			1.8 Ω						
3			18 Ω						
4			50 Ω		+2 %	0.1 Ω			
5			180 Ω						
6			500 Ω						
7			1800 Ω					+6 %	1 Ω
8		0.2 Ω	+(2 % + 4)		0.01 Ω				
9		1.8 Ω							
10		18 Ω							
11		50 Ω	+2 %			0.1 Ω			
12		180 Ω							
13		500 Ω							
14		1800 Ω					+6 %	1 Ω	

Change #3, 121

On page 33, Table 10, add the MP12:

MP12	Battery Holder	1676850	1
------	----------------	---------	---

Change #4 593

On page 10, replace the **Test Signals** table with:

Test Signals

RCD Type	Test Signal Description
AC (sinusoidal)	The waveform is a sinewave starting at zero crossing, polarity determined by phase selection (0 ° phase starts with low to high zero crossing, 180 ° phase starts with high to low zero crossing). The magnitude of the test current is $I_{\Delta n} \times \text{Multiplier}$ for all tests.
A (half wave)	The waveform is a half wave rectified sinewave starting at zero, polarity determined by phase selection (0 ° phase starts with low to high zero crossing, 180 ° phase starts with high to low zero crossing). The magnitude of the test current is $0.7 \times I_{\Delta n} \text{ (rms)} \times \text{Multiplier}$ for all tests where the multiplier is $\times 0.5$ ($\times 1/2$). The magnitude of the test current is $2.0 \times I_{\Delta n} \text{ (rms)} \times \text{Multiplier}$ for all tests where both the multiplier is $\geq \times 1$ and $I_{\Delta n} = 0.01\text{A}$. The magnitude of the test current is $1.4 \times I_{\Delta n} \text{ (rms)} \times \text{Multiplier}$ for all tests for all other settings.
B (DC)	This is a smooth DC current according to EN61557-6 Annex A